

Instructions

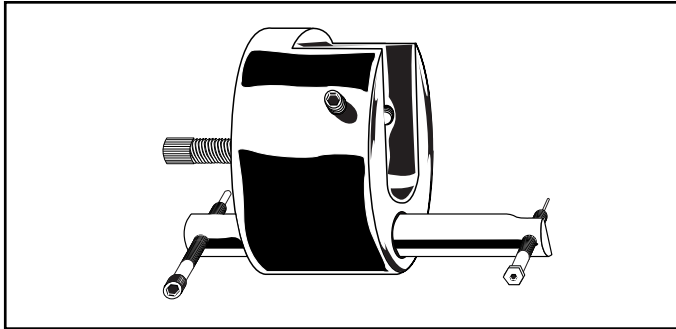

Lever Handle Remover

No. LHR-100



HPC's Lever Lock Handle Remover is designed to quickly remove locked lever handles for servicing. Ideal when picking the lock is not an option.

1. Choose the proper size Pin Depressing Screw and determine which end of the Slide Post will allow easiest access to the lever lock handle retaining-pin and assemble as shown (see fig. 1).
2. Back off Drive Bolt and Holding Bolts before placing Hub onto lever lock handle (see fig. 2).
3. Keeping the Hub centered on the handle, tighten the two Holding Bolts equally to lock Hub onto lever lock handle (see fig. 3). **Do not over-tighten. Care should be taken so as not to crush the nylon tips.**
4. Secure the Drive Bolt against the plug (see fig. 4).
5. Line up the Pin Depressing Screw with the lever lock handle retaining-pin and tighten slowly, depressing the pin. Only depress the retaining pin enough to clear the thickness of the handle. This is done to hold the retaining pin in while removing the lever handle (see fig. 5).

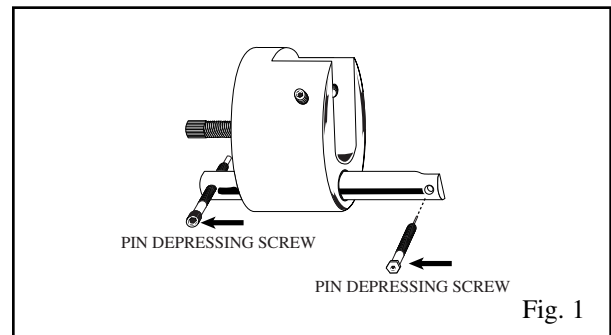

Fig. 1

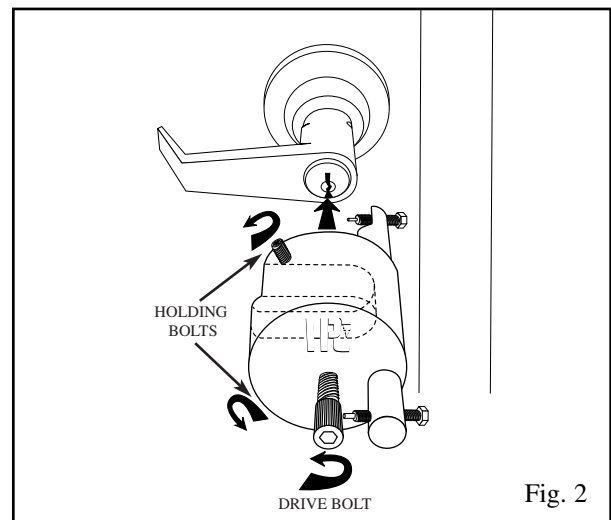

Fig. 2

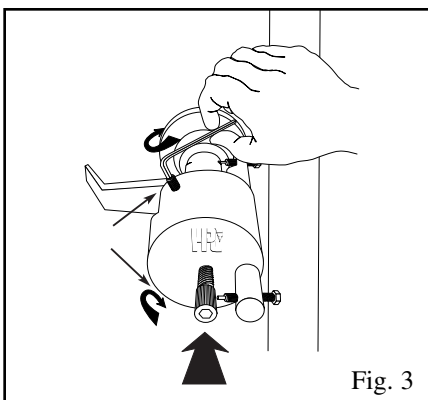

Fig. 3

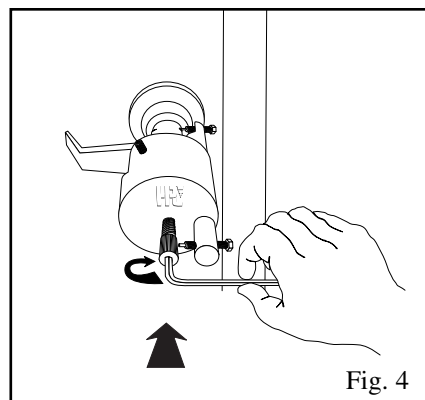

Fig. 4

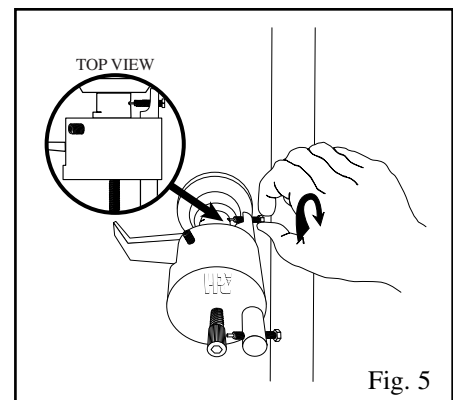

Fig. 5

020503 35T00-280-00

(continued)

Lever Handle Remover instructions (continued)



6. Slowly turn the Drive Bolt to begin pulling the lever handle away from the lock body, approximately 1/16" to 1/8" (see fig. 6).
7. **Back off the Pin Depressing Screw** to completely clear the handle, so as not to damage the Screw or the lock during removal of the handle (see fig. 7).
8. Continue to tighten the Driver Bolt until the lever lock handle can be removed by hand. The cylinder will either be loose within the lever handle or will remain loosely in the chassis (if in the chassis simply remove by hand). See fig. 8.
9. Loosen the Holding Screws and remove the Hub from the lock handle (see fig. 9).
10. Service the lock and replace the handle in the usual manner.

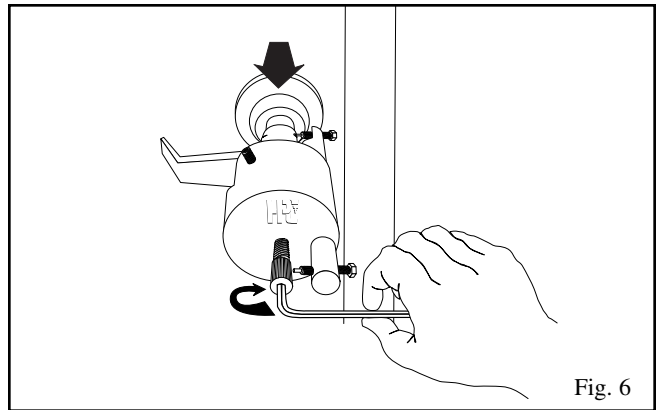

Fig. 6

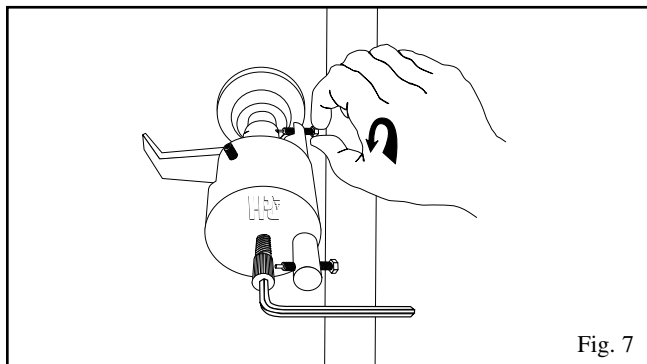

Fig. 7

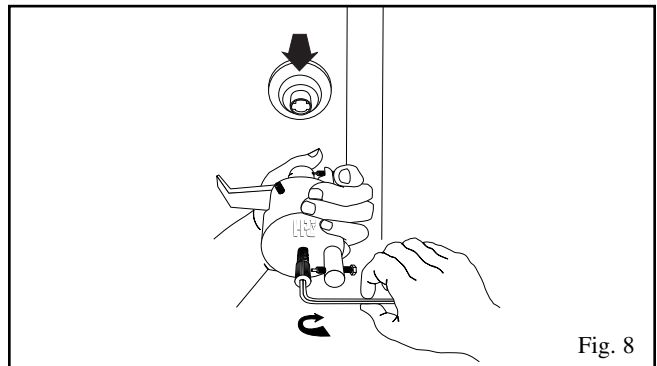

Fig. 8

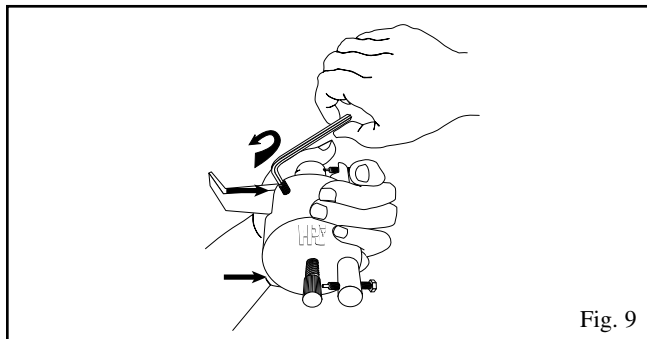
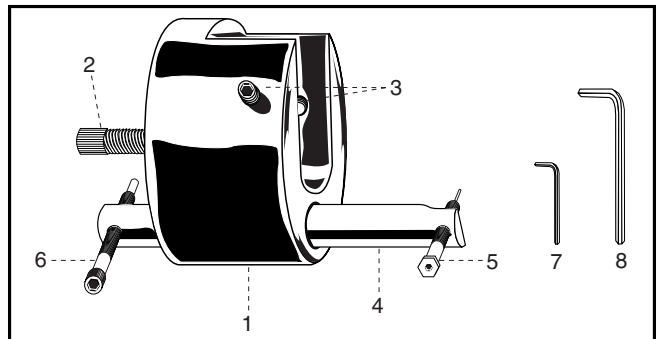

Fig. 9



Replacement Parts

PLEASE NOTE:

The tips of the Pin Depressing Screws are very fragile. Failure to back them off as described in steps 6 and 7 will destroy the tips and may damage the lock.

#	Description	Stock #
1.	Main Hub	LHR-HUB
2.	Drive Bolt	LHR-DBOLT
3.	Holding Bolts (2)	LHR-HBOLT
4.	Slide Post	LHR-POST
5.	Small Pin Depressing Screw (2)	LHR-SSCREW
6.	Large Pin Depression Screw (Corbin) (1)	LHR-LSCREW
7.	3/32" Allen Wrench	
8.	5/32" Allen Wrench	